

Bullet Resistant Wood Door Section - Levels 1, 2, 3 & 6

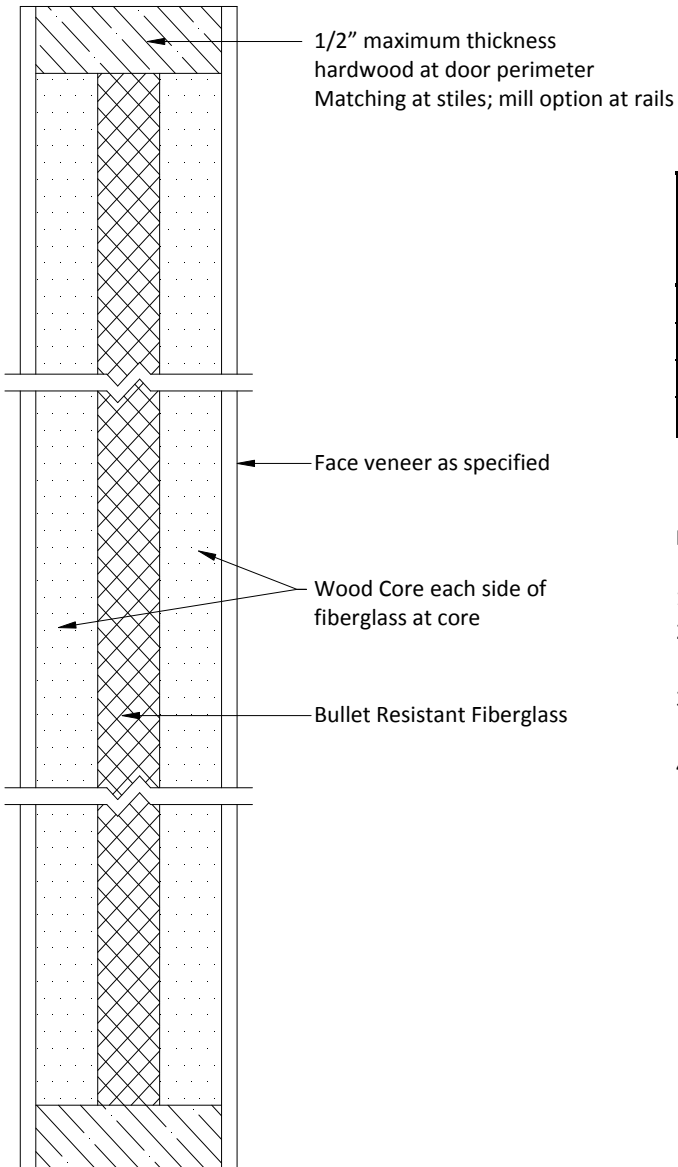

UL752 LEVEL	DOOR THICKNESS	3070 DOOR WEIGHT (POUNDS)	4070 DOOR WEIGHT (POUNDS)
1	1-3/4"	178	238
2	1-3/4"	206	274
3	1-3/4"	231	308
6	1-3/4"	206	274

NOTES:

1. Bullet Resistant door systems are designed to meet UL752 standards.
2. Door weights are high due to bullet resistant core content. Select hardware for the application accordingly.
3. For paired openings an A&L furnished bullet resistant metal edge and astragal set must be used to shield at meeting stiles.
4. Use of door without approved frame is not recommended and not warranted.